

4 Bedroom 12M X 3M

STARTING FROM:
\$93,000* ex. gst

This popular 12 m × 3 m modular building is purpose-built for workers' accommodation, especially suited to mining camps and remote job sites. It features four private bedrooms, each furnished with a wardrobe, office desk, and chair—providing dedicated space for both rest and productivity. Designed for use alongside communal bathroom and toilet facilities, this modular is constructed with durable steel framing for strength and longevity and is fully air-conditioned to ensure comfort in challenging climates.

FEATURES:

- ✓ 4x Private bedrooms
- ✓ Fully air-conditioned
- ✓ Wardrobe & Office Desk / Chair
- ✓ Quality Steel Frames
- ✓ Class 3, C2 cyclone rated

**Any upgrades will be subject to additional charges. Such additional costs will be outlined in a separate written agreement and are not included in the starting price.*

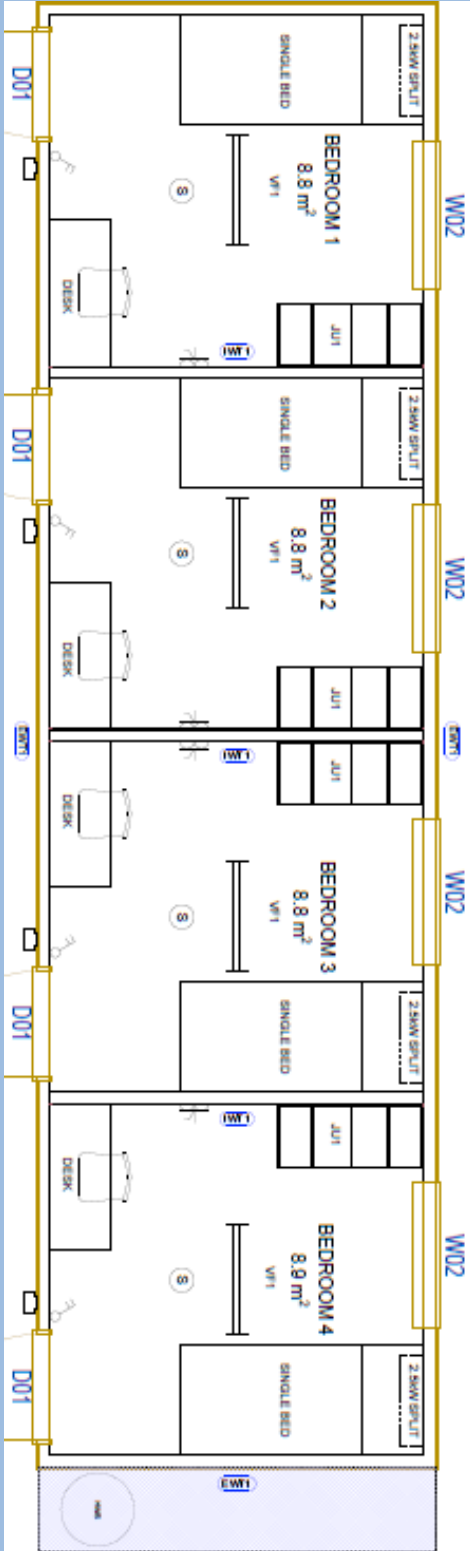

ACC4BR-12-3