

2 Bedroom 12M X 3M

**STARTING FROM:
\$132,500*** ex. gst

Designed for comfort and functionality, this 12m x 3m modular building features two generously sized bedrooms at opposite ends, each capable of fitting a double bed. Centrally located is a fully equipped kitchen and bathroom, offering convenient shared amenities. There's also space to include a dining table, making it ideal for longer stays or shared living. Built for durability with a steel frame structure, this layout is perfect for mining camps, remote work sites, or temporary housing solutions.

FEATURES:

- ✓ 2x bedrooms
- ✓ 1x bathroom
- ✓ Dining / Kitchen
- ✓ Fully air-conditioned
- ✓ Wardrobe & Office Desk / Chair
- ✓ Quality Steel Frames
- ✓ Class 3, C2 cyclone rated

**Any upgrades will be subject to additional charges. Such additional costs will be outlined in a separate written agreement and are not included in the starting price.*

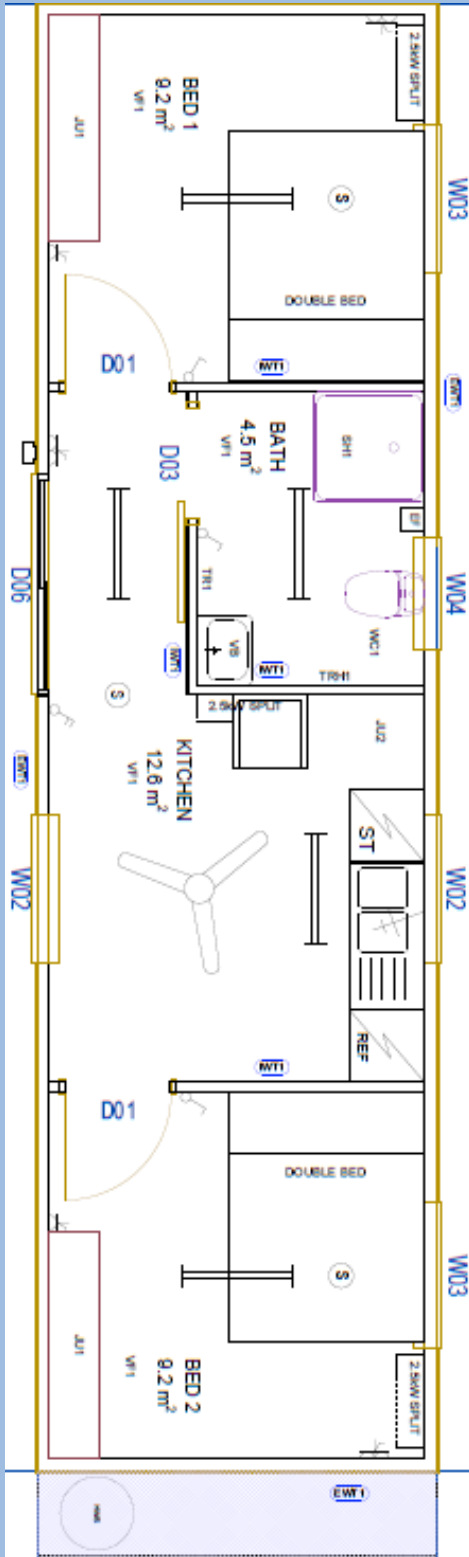

BH2KB-12-3